

WATTSTOPPER® DIMMERS

TITAN® SERIES

THE COMPLETE PACKAGE

MULTI-GANG DIMMER SOLUTIONS RIGHT OUT OF THE BOX



designed to be better.™

 **legrand**®

TITAN® SERIES DIMMERS — EVERYTHING YOU NEED FOR

FAST, COST-EFFECTIVE INSTALLATION.

Included screwless wall plate components make it easy to assemble a custom multi-gang wall plate in any configuration — saving money and time.

Included end-caps and spacers screw directly to heat sinks; center plate easily snaps on and off.

Improved heat management enables superior load ratings.

High-reliability design with built-in surge and static protection plus oversize output devices to stand up to abuse.

Enclosed slider helps prevent dust and dirt contamination.

Optional built-in label holder enables instant circuit identification; looks clean and professional.

Exclusive adjustable limit control in incandescent dimmers saves energy and extends bulb life — reduces maximum output by up to 10 percent.

Air-gap switch

Power-failure memory retains presets through power outages.

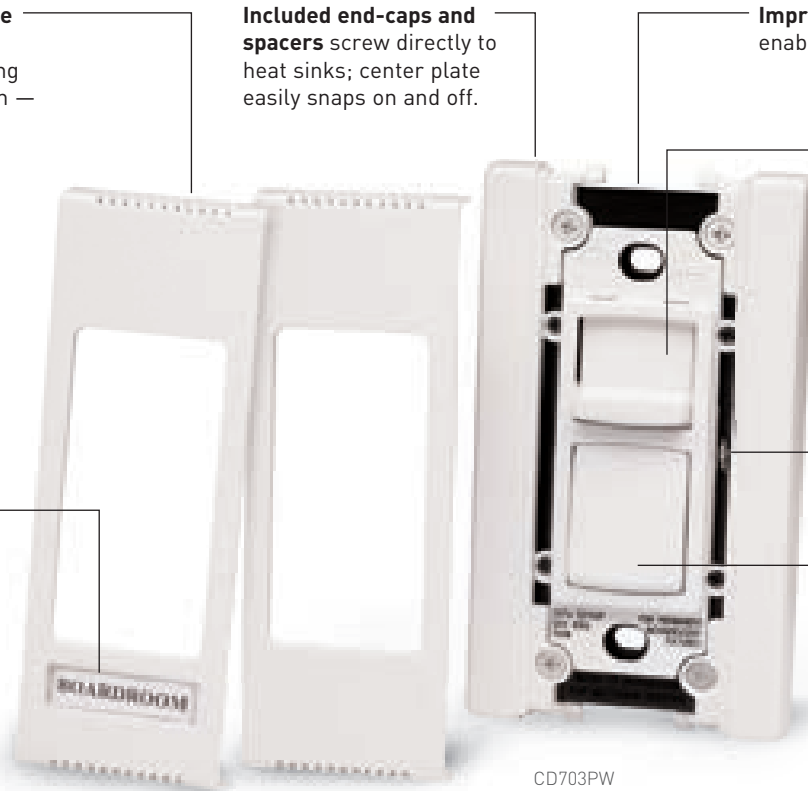

Ganging conventional dimmers used to require costly, customized wall plates that couldn't be ordered until a configuration was finalized. Titan® Series Dimmers change all that. Unlike the others, Titan Dimmers are a complete solution that saves time and money and offers end-users a superior, more convenient, better-looking multi-gang installation.

Each comes with all the screwless wall plate components necessary for installing the dimmer in either a single- or multi-gang configuration.

That means you can quickly and easily assemble a custom wall plate—to any configuration—on the spot, and with no added cost.

In addition, because Titan Dimmer Wall Plates incorporate visible circuit labels (easily produced on any computer), they make it simple to identify what each device controls while retaining a clean, professional appearance. With Titan Dimmers, you'll discover how easy and cost-effective multi-gang installations can be!



Titan® Dimmers



CD1100W

COMPLETE LINE — slide-to-OFF and preset models; 700W, 1100W, 1600W and 2000W incandescent and magnetic low voltage; 120V and 277V 2-, 3- and 4-wire fluorescent and 4-wire LED; plus dehummer and continuously variable fan speed controls.

Available in seven* colors to match any décor.

***COLOR DESIGNATION**

I	Ivory	LA	Light Almond
W	White	—	Brown
GRY	Gray	RED	Red (made to order only)
BK	Black		

***Adaptor kit enables matching installation of standard Decorator Devices** — receptacles, switches, GFCIs and more.

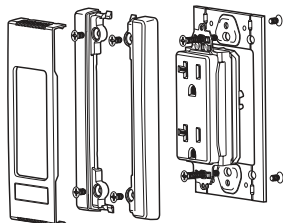

CATALOG NO.	DESCRIPTION	RATINGS
INCANDESCENT		
CD700*	Single-Pole, Slide-to-OFF	700W
CD1100*		1100W
CD1600*		1600W
CD2000*		2000W
CD703P*	Single-Pole/3-Way, Preset	700W
CD1103P*		1100W
CD1603P*		1600W
CD2003P*		2000W
MAGNETIC LOW VOLTAGE		
CDLV700*	Single-Pole, Slide-to-OFF	700VA
CDLV1100*		1100VA
CDLV1600*		1600VA
CDLV703P*	Single-Pole/3-Way, Preset	700VA
CDLV1103P*		1100VA
CDLV1603P*		1600VA
FAN SPEED CONTROL		
CDSC6*	Variable Speed	6A
CDSC12*		12A
CDDH16*	Dehummer, 4-Speed	1.6A
FLUORESCENT		
CDFB5*	2-Wire, Single-Pole, Slide-to-OFF	5A, 120V
CDFB8*		8A, 120V
CDFB10*		10A, 120V
CDFB16*		16A, 120V
CDFB7-277*		7A, 277V
CDFB10-277*		10A, 277V
CD3FB16*	3-Wire Electronic, Single-Pole, Slide-to-OFF	120V, 16A
CD3FB10277*		277V, 10A
CD4FB*	4-Wire Electronic, Slide-to-OFF	24VDC**
CDFB53P*	2-Wire Electronic, Single-Pole/3-Way, Preset	5A, 120V
CDFB83P*		8A, 120V
CDFB103P*		10A, 120V
CDFB163P*		16A, 120V
CDFB73-P277*		7A, 277V
CDFB103-P277*		10A, 277V
CD3FB163P*	3-Wire Electronic, Single-Pole/3-Way, Preset	120V, 16A
CD3FB103P277*		277V, 10A
CD4FB3P*	4-Wire Electronic, Single-Pole/3-Way, Preset	24VDC**
POWER PACK		
BZ50	Universal Voltage Power Pack	
FLUORESCENT & LED		
CD4FBL*	4-Wire, Single-Pole, 0-10V Dimmer — Int. Power Pack	120/277V
CD4FBL3P*	4-Wire, Single-Pole/3-Way, Preset, 0-10V Dimmer — Int. Power Pack	0-10VDC
ADAPTOR KIT†		
CDADAPTORKIT	Decorator Device Adaptor Kit	

**Requires BZ50 Power Packs

See instruction sheets for lists of compatible dimming ballasts.

Derating for multi-gang installations

Dimmer Catalog Number	1-Gang Installation	Fins: NOT Removed		Fins: Removed	
		2-Gang Installation	3- or More Gang Installation	2-Gang Installation	3- or More Gang Installation
CD700	700W	700W	700W	700W	700W
CDLV700	700VA	700VA	700VA	700VA	700VA
CD703P	700W	700W	700W	700W	700W
CDLV703P	700VA	700VA	700VA	700VA	700VA
CD1100	1100W	1100W	1000W	1000W	900W
CDLV1100	1100VA	1100VA	1000VA	1000VA	850VA
CD1103P	1100W	1100W	1000W	1000W	950W
CDLV1103P	1100VA	1100VA	1000VA	1000VA	850VA
CD1600	1600W	1600W	1600W	1600W	1550W
CDLV1600	1600VA	1600VA	1600VA	1600VA	1550VA
CD1603P	1600W	1600W	1600W	1600W	1550W
CDLV1603P	1600VA	1600VA	1600VA	1600VA	1550VA
CD2000	2000W	2000W	2000W	n/a	n/a
CD2003P	2000W	2000W	2000W	n/a	n/a

Wall box gang requirements

1. Choose fin style (not removed or removed).
2. Select the column for the number of narrow dimmers to be installed.
3. Select the row for the number of wide dimmers to be installed.
4. The number at the intersection of the selected column and row indicates the number of wall box gangs required.

Fins: NOT Removed							
Wide Dimmers	Narrow Dimmers						
	0	1	2	3	4	5	6
0	0	1	1+1*	4	4+1*	7	7+1*
1	1	3	5	6	8	9	11
2	4	5	7	8	10	11	13
3	6	8	9	11	12	14	15
4	9	10	12	13	15	16	
5	11	13	14	16			
6	14	15					

*Refer to instruction sheets for exact placement of boxes for even number of narrow dimmers.

Fins: Removed							
Wide Dimmers	Narrow Dimmers						
	0	1	2	3	4	5	6
0	0	1	2	3	4	5	6
1	1	3	4	5	6	7	8
2	3	4	5	6	7	8	9
3	5	6	7	8	9	10	11
4	7	8	9	10	11	12	13
5	9	10	11	12	13	14	15
6	11	12	13	14	15	16	17

©2016 Legrand BR1568 All Rights Reserved 3116

designed to be better.™



2700 Zanker Road
Suite 168
San Jose, CA 95134
www.legrand.us

570 Applewood Crescent
Vaughan, Ontario L4K 4B4
905.738.9195
www.legrand.ca

For additional technical or application-specific information, call 800-223-4185 or visit our website at www.legrand.us. We're eager to put our expertise to work for you.

